



*We Keep It Cool.*



**TRANSPORT REFRIGERATION**



# CONTENTS

About Us .....	02
Our Team .....	02
TM100 .....	03
TM250 .....	04
TM500 .....	05
TM-050 RT .....	06
TM-100 RT .....	07
TM-250 RT .....	08
TMB 2500U .....	09
TMB 3000N .....	10
TMB 3300N .....	11
TMB 4200N .....	12
TMB 3200W .....	13
TMB 4200W .....	14
TMB 5500W .....	15
FRAMEC Bodies .....	16
Framec Solutions .....	17
Van Insulation .....	18
THERMO KING T1000R .....	19
THERMO KING SLX400 .....	20
Service & Parts .....	21

24 Penny Place, Arndell  
Park NSW 2148  
P: 1300 798 380

SALES/SERVICE/PARTS  
P:1300 798 380  
sales@thermalmark.com.au  
service@thermalmark.com.au  
parts@thermalmark.com.au

*Quality you can count on to get the job done*



## ABOUT US

Thermal Mark provides refrigerated transport equipment to refrigerate trucks, semi-trailers, utes and vans. We're focused on matching excellent service and quality products at a competitive price.

Our company is service and repair focused; something that comes with being the largest independent refrigeration repairer in NSW. We specialise in service, maintaining fleets with all brands of transport refrigeration systems and tailgate loaders. Whether it's Thermo King, Carrier or even bus air-conditioning, we have you covered. We can even service your Dholandia or Anteo tail lift in the same visit.

We have built up a large inventory of quality spare parts to service our independent repairers throughout Australia. Need a spare part? We'd love to talk through what you require.

At Thermal Mark, we're committed to finding the unique service to suit your transport refrigeration needs.

For refrigerated transport units, service and repairs, give us a call and let's talk about what we can do for you.



## OUR TEAM

At Thermal Mark our culture of quality and customer satisfaction is something lived by every one of our employees. It's what makes us great at what we do.

We are a hardworking, friendly bunch of multi-skilled individuals with the knowledge to address all your vehicle refrigeration needs. The Thermal Mark team includes:

- Refrigeration and air conditioning technicians
- Diesel and automotive mechanics
- Hydraulic technicians
- Van fibreglassing
- Fitter machinists
- Auto electricians

# TM100 SERIES

## REFRIGERATION TRANSPORT SYSTEM

TM-100 Series by Thermal Mark is designed for fresh, frozen and deep frozen applications on small sized trucks.

The compressor is driven by the truck engine. Integrated 240v electric standby model available upon request, (OED) Off Engine Drive supplied as standard.

### FEATURES & BENEFITS

- » **Optimum Performance**  
for superior cooling & less fuel consumption
- » **High Capacity & Airflow**  
to ensure even temperature distribution
- » **Exceptional Pull-Down**  
Capacity after regular door openings
- » **Low Operating Noise**  
allowing unrestricted deliveries in residential areas
- » **Intelligent & User Friendly**  
control system with digital in-cab display
- » **Electric Standby**  
240v
- » **Affordable Reliability**  
knowing your unit will have a long life cycle at a small cost

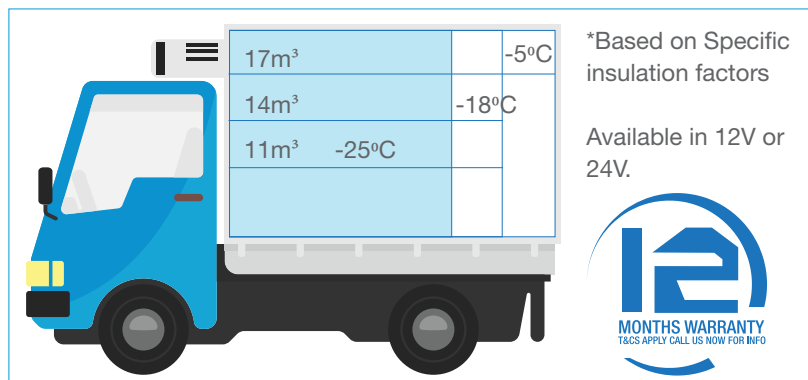

Refrigerant Temperature		Road Operation TM-100II	Electric Operation TM-100 ESC
	°C	kW	kW
R-404a	1.7	3.52	2.78
	-17.8	1.9	1.47
	-29	1.32	0.88
Condenser Dimensions (mm/ WxDxH)			
Specifications	Road Operation TM-100II		Electric Operation TM-100 ESC
	1115 x 464 x 267 - 25kg		1220 x 620 x 327 - 115kg
	Slimline Evaporator 12 or 24 Volt Dimensions (mm/ WxDxH)		
	991 x 620 x 168 - 24kg		

Quality you can count on to get the job done



# TM250 SERIES

## REFRIGERATION TRANSPORT SYSTEM

TM-250 Series by Thermal Mark is designed for fresh, frozen and deep frozen applications on medium sized trucks.

The compressor is driven by the truck engine. Integrated 240v electric standby model available upon request, (OED) Off Engine Drive supplied as standard.

### FEATURES & BENEFITS

- » **Optimum Performance**  
for superior cooling & less fuel consumption
- » **High Capacity & Airflow**  
to ensure even temperature distribution
- » **Exceptional Pull-Down**  
Capacity after regular door openings
- » **Low Operating Noise**  
allowing unrestricted deliveries in residential areas
- » **Intelligent & User Friendly**  
control system with digital in-cab display
- » **Electric Standby**  
240v
- » **Affordable Reliability**  
knowing your unit will have a long life cycle at a small cost



TM250 Condenser



Evaporator Unit



Control Panel



19m <sup>3</sup>	-18°C
17m <sup>3</sup>	-25°C

\*Based on Specific insulation factors

Available in 12V or 24V.



**12 MONTHS WARRANTY**  
T&CS APPLY CALL US NOW FOR INFO

Refrigerant Temperature		Road Operation TM-250II	Electric Operation TM-250 ESC
	°C	kW	kW
R-404a	1.7	4.34	3.22
	-17.8	2.34	1.81
	-29	1.51	1.22
Condenser Dimensions (mm/ WxDxH)			
Specifications		Road Operation TM-250II	Electric Operation TM-250 ESC
		1153 x 430 x 372 - 32kg	1220 x 620 x 327 - 124kg
		Evaporator Dimensions (mm/ WxDxH)	
		860 x 585 x 328 - 29kg	

*Quality you can count on to get the job done*

# TM500 SERIES

## REFRIGERATION TRANSPORT SYSTEM

TM-500 Series by Thermal Mark is designed for fresh, frozen and deep frozen applications on large sized trucks.

The compressor is driven by the truck engine. Integrated 240v electric standby model available upon request, (OED) Off Engine Drive supplied as standard.

## FEATURES & BENEFITS

- » **Optimum Performance**  
for superior cooling & less fuel consumption
- » **High Capacity & Airflow**  
to ensure even temperature distribution
- » **Exceptional Pull-Down**  
Capacity after regular door openings
- » **Low Operating Noise**  
allowing unrestricted deliveries in residential areas
- » **Intelligent & User Friendly**  
control system with digital in-cab display
- » **Electric Standby**  
240v
- » **Affordable Reliability**  
knowing your unit will have a long life cycle at a small cost

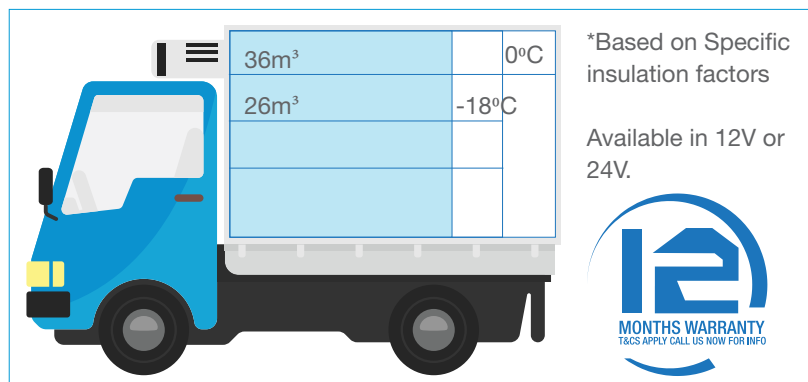

Refrigerant Temperature		Road Operation TM-500II	Electric Operation TM-500 ESC
	°C	kW	kW
R-404a	1.7	4.69	3.96
	-17.8	2.56	1.90
	-29	1.90	1.32
Condenser Dimensions (mm/ WxDxH)			
Specifications		Road Operation TM-500II	Electric Operation TM-500 ESC
		1304 x 465 x 372 - 37kg	1320 x 556 x 430 - 133kg
		Evaporator Dimensions (mm/ WxDxH)	
		1140 x 585 x 328 - 31kg	

# TM-050 RT SERIES

## REFRIGERATION TRANSPORT SYSTEM

TM-050 RT Series by Thermal Mark is designed for chilled and frozen applications on small to medium sized vans.

The compressor is driven by the truck engine. Integrated 240v electric standby model available upon request, (OED) Off Engine Drive supplied as standard.

## FEATURES & BENEFITS

- » **Optimum Performance**  
for superior cooling & less fuel consumption
- » **High Capacity & Airflow**  
to ensure even temperature distribution
- » **Exceptional Pull-Down**  
Capacity after regular door openings
- » **Low Operating Noise**  
allowing unrestricted deliveries in residential areas
- » **Intelligent & User Friendly**  
control system with digital in-cab display
- » **Electric Standby**  
240v
- » **Affordable Reliability**  
knowing your unit will have a long life cycle at a small cost

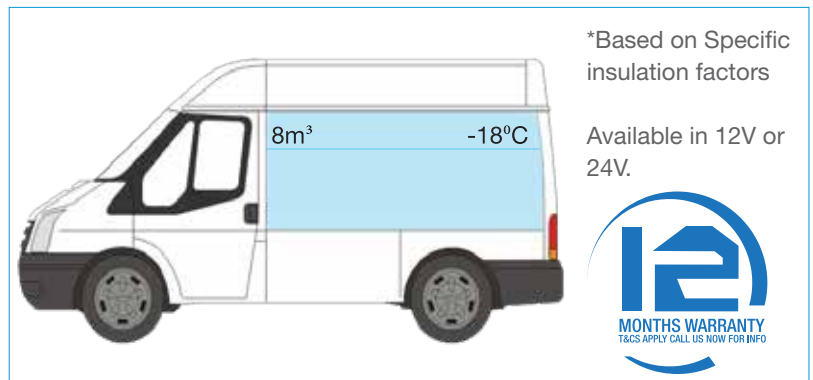

Refrigerant Temperature		Road Operation TM-090RT	Electric Operation TM-090RT
	°C	kW	kW
R-404a	1.7	3.34	2.64
	-17.8	1.80	1.39
	-29	1.25	0.83
Specifications		Condenser Dimensions (mm/ WxDxH)	
		Road Operation TM-090RT	Electric Operation TM-090RT
		1005.4 x 620 x 172 - 28kg	Under Mount Compressor
		Evaporator Dimensions (mm/ WxDxH)	
		799 x 603 x 168 - 21kg	

# TM-100 RT SERIES

## REFRIGERATION TRANSPORT SYSTEM

TM-100 RT Series by Thermal Mark is designed for chilled and frozen applications on small to medium sized vans.

The compressor is driven by the truck engine. Integrated 240v electric standby model available upon request, (OED) Off Engine Drive supplied as standard.

## FEATURES & BENEFITS

- » **Optimum Performance**  
for superior cooling & less fuel consumption
- » **High Capacity & Airflow**  
to ensure even temperature distribution
- » **Exceptional Pull-Down**  
Capacity after regular door openings
- » **Low Operating Noise**  
allowing unrestricted deliveries in residential areas
- » **Intelligent & User Friendly**  
control system with digital in-cab display
- » **Electric Standby**  
240v
- » **Affordable Reliability**  
knowing your unit will have a long life cycle at a small cost

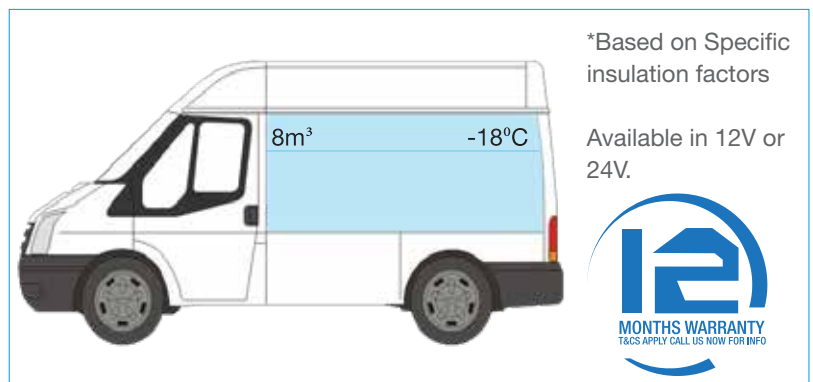

Refrigerant Temperature		Road Operation TM-090RT	Electric Operation TM-090RT
	°C	kW	kW
R-404a	1.7	3.52	2.78
	-17.8	1.9	1.47
	-29	1.32	0.88
Specifications		Condenser Dimensions (mm/ WxDxH)	
		Road Operation TM-090RT	Electric Operation TM-090RT
		1005.4 x 620 x 172 - 28kg	Under Mount Compressor
		Evaporator Dimensions (mm/ WxDxH)	
		991 x 620 x 168 - 24kg	



# TM-250 RT SERIES

## REFRIGERATION TRANSPORT SYSTEM

TM-250 RT Series by Thermal Mark is designed for chilled and frozen applications on large long wheel base high roof vans.

The compressor is driven by the truck engine. Integrated 240v electric standby model available upon request, (OED) Off Engine Drive supplied as standard.

## FEATURES & BENEFITS

- » **Optimum Performance**  
for superior cooling & less fuel consumption
- » **High Capacity & Airflow**  
to ensure even temperature distribution
- » **Exceptional Pull-Down**  
Capacity after regular door openings
- » **Low Operating Noise**  
allowing unrestricted deliveries in residential areas
- » **Intelligent & User Friendly**  
control system with digital in-cab display
- » **Electric Standby**  
240v
- » **Affordable Reliability**  
knowing your unit will have a long life cycle at a small cost

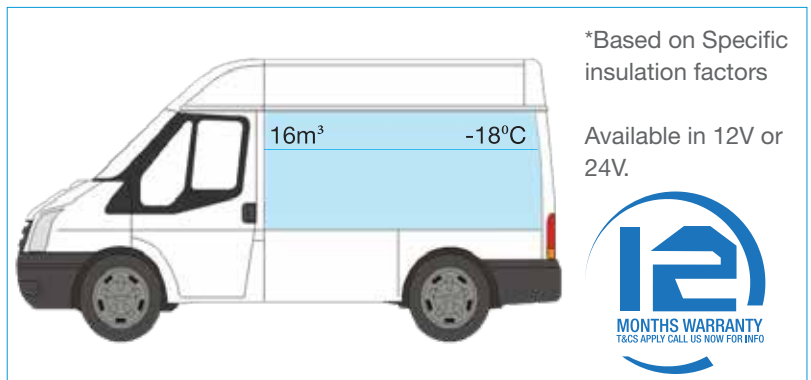

Refrigerant Temperature		Road Operation TM-110RT	Electric Operation TM-110RT
	°C	kW	kW
R-404a	1.7	4.34	3.22
	-17.8	2.34	1.81
	-29	1.51	1.22
Specifications		Condenser Dimensions (mm/ WxDxH)	
		Road Operation TM-110RT	Electric Operation TM-110RT
		1244 x 680 x 172 - 38kg	Under Mount Compressor
		Evaporator Dimensions (mm/ WxDxH)	
		860 x 585 x 328 - 29kg	

# TMB2500U SERIES

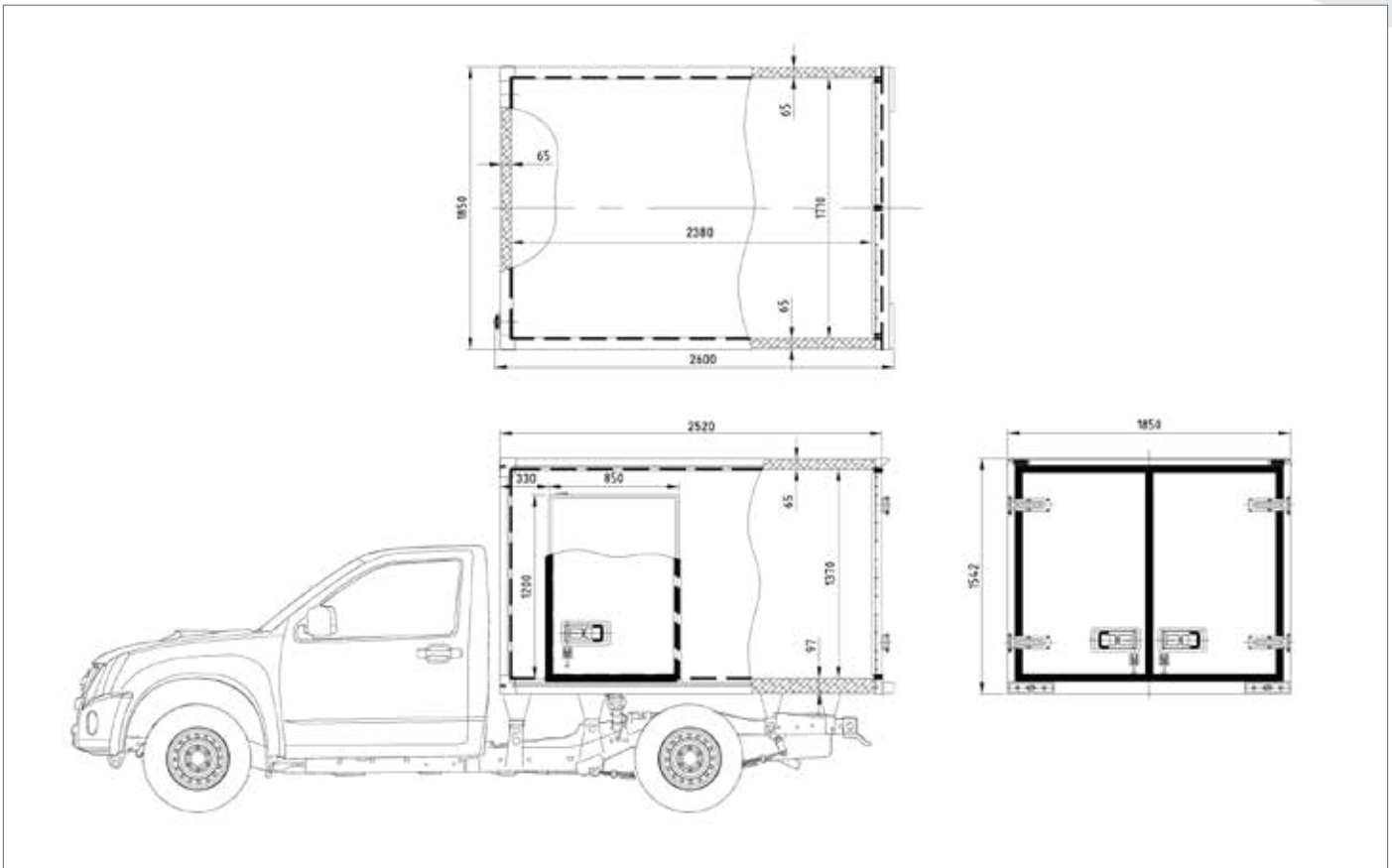

Our Fibreglass bodies are engineered and designed to provide superior insulation and durability, manufactured with quality fibreglass and insulation materials across our entire range of freezer spec bodies.

## FEATURES & BENEFITS

- » State of the Art Panel Technology FRP/PUR/FRP
- » Fully welded Aluminium checker plate flooring and internal kick plates all round (to avoid damaging the floor)
- » Internal recessed lights and recessed switch
- » Stainless steel recessed door hardware and Aluminium extrusions (less extrusions when adding decals for advertising)
- » Interior LED Cargo light and rear running lights and exterior reflectors
- » EPDM Rubber Seal
- » 24 Months Structural and Hardware Warranty
- » Truck Body Weight: Approx. 411Kg (Fitted body without fridge)

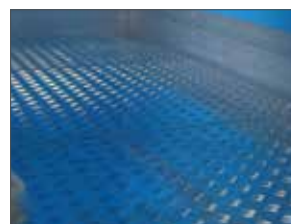

Stainless steel checker plate floor



Internal recessed lights



# TMB3000N SERIES

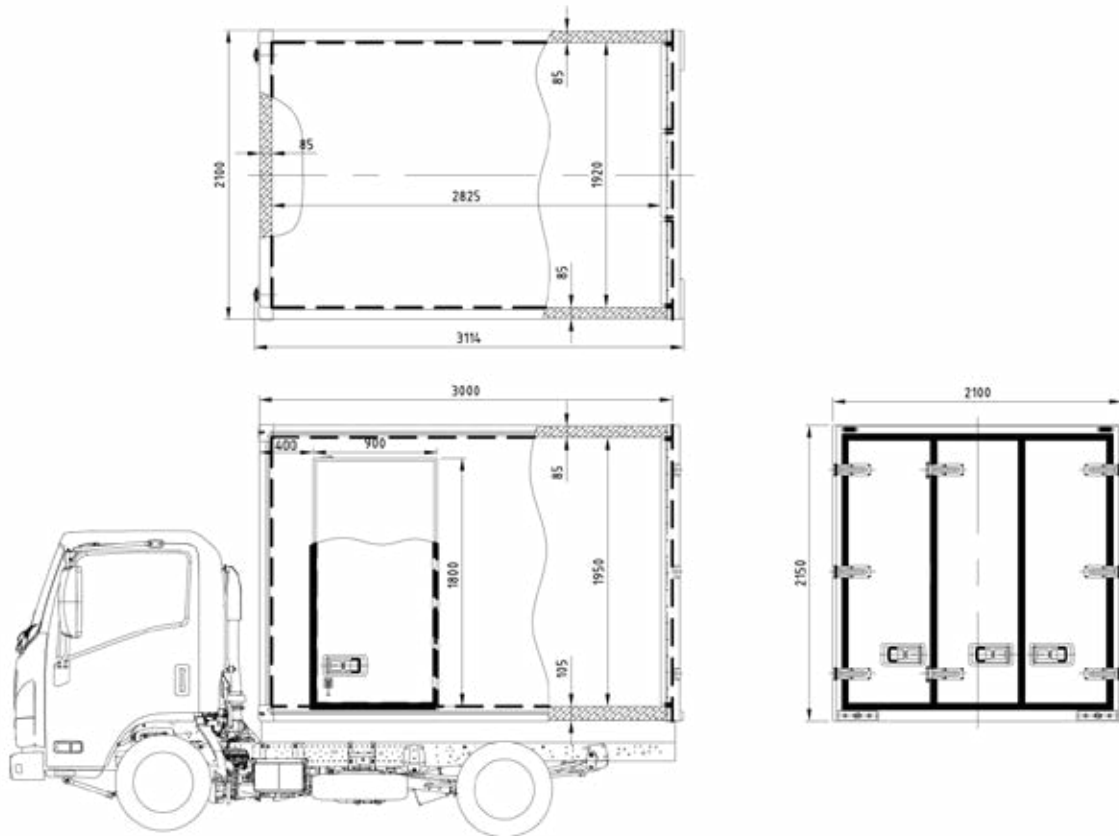

Our Fibreglass bodies are engineered and designed to provide superior insulation and durability, manufactured with quality fibreglass and insulation materials across our entire range of freezer spec bodies.

## FEATURES & BENEFITS

- » State of the Art Panel Technology FRP/PUR/FRP
- » Fully welded Aluminium checker plate flooring and internal kick plates all round (to avoid damaging the floor)
- » Internal recessed lights and recessed switch
- » Stainless steel recessed door hardware and Aluminium extrusions (less extrusions when adding decals for advertising)
- » Interior LED Cargo light and rear running lights and exterior reflectors
- » EPDM Rubber Seal
- » 24 Months Structural and Hardware Warranty
- » Truck Body Weight: Approx. 925Kg (Fitted body without fridge)

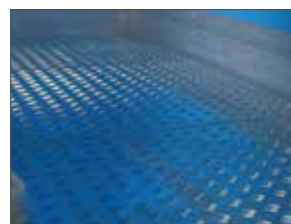

Stainless steel checker plate floor



Internal recessed lights



*Quality you can count on to get the job done*

# TMB3300N SERIES

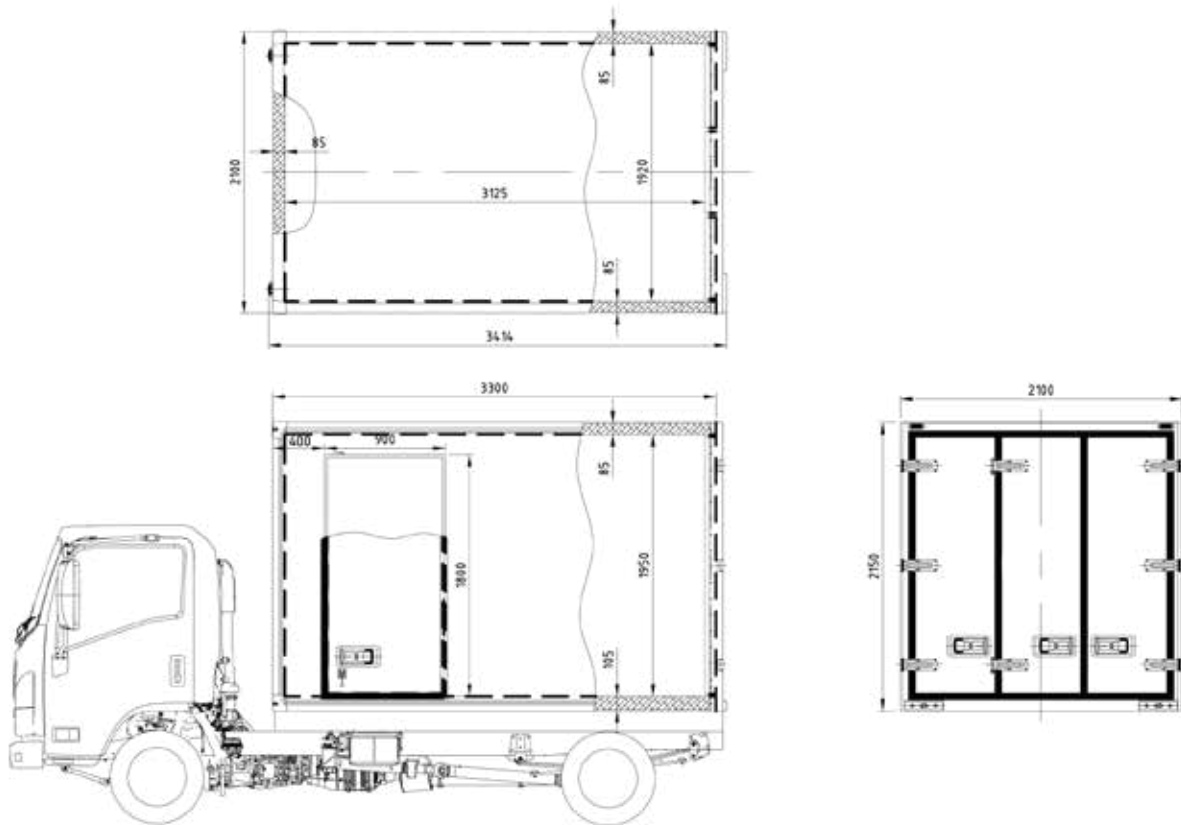

Our Fibreglass bodies are engineered and designed to provide superior insulation and durability, manufactured with quality fibreglass and insulation materials across our entire range of freezer spec bodies.

## FEATURES & BENEFITS

- » State of the Art Panel Technology FRP/PUR/FRP
- » Fully welded Aluminium checker plate flooring and internal kick plates all round (to avoid damaging the floor)
- » Internal recessed lights and recessed switch
- » Stainless steel recessed door hardware and Aluminium extrusions (less extrusions when adding decals for advertising)
- » Interior LED Cargo light and rear running lights and exterior reflectors
- » EPDM Rubber Seal
- » 24 Months Structural and Hardware Warranty
- » Truck Body Weight: Approx. 965Kg (Fitted body without fridge)

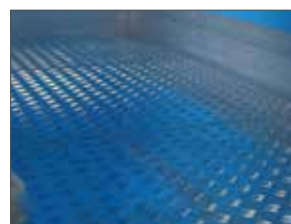

Stainless steel checker plate floor



Internal recessed lights



*Quality you can count on to get the job done*

# TMB4200N SERIES

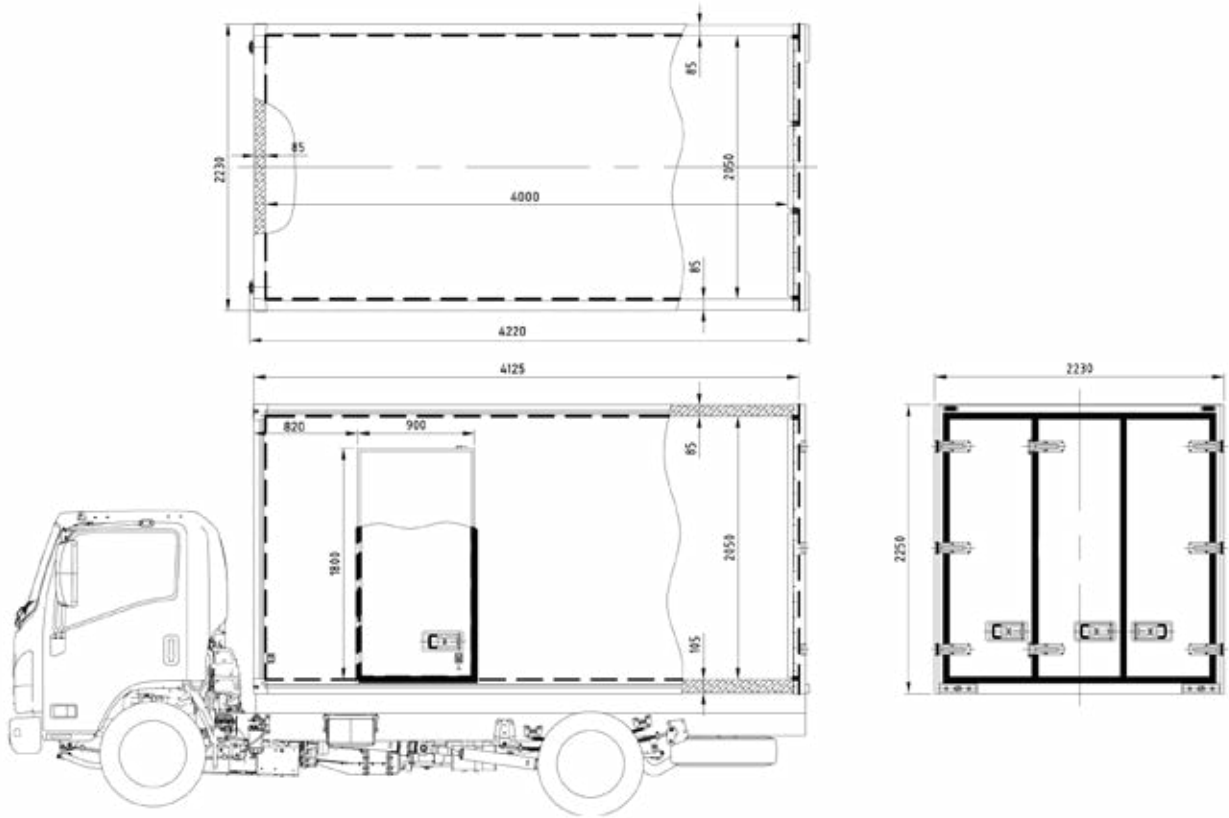

Our Fibreglass bodies are engineered and designed to provide superior insulation and durability, manufactured with quality fibreglass and insulation materials across our entire range of freezer spec bodies.

## FEATURES & BENEFITS

- » State of the Art Panel Technology FRP/PUR/FRP
- » Fully welded Aluminium checker plate flooring and internal kick plates all round (to avoid damaging the floor)
- » Internal recessed lights and recessed switch
- » Stainless steel recessed door hardware and Aluminium extrusions (less extrusions when adding decals for advertising)
- » Interior LED Cargo light and rear running lights and exterior reflectors
- » EPDM Rubber Seal
- » 24 Months Structural and Hardware Warranty
- » Truck Body Weight: Approx. 1145Kg (Fitted body without fridge)

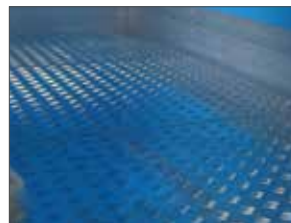

Stainless steel checker plate floor



Internal recessed lights



*Quality you can count on to get the job done*



# TMB3200W SERIES

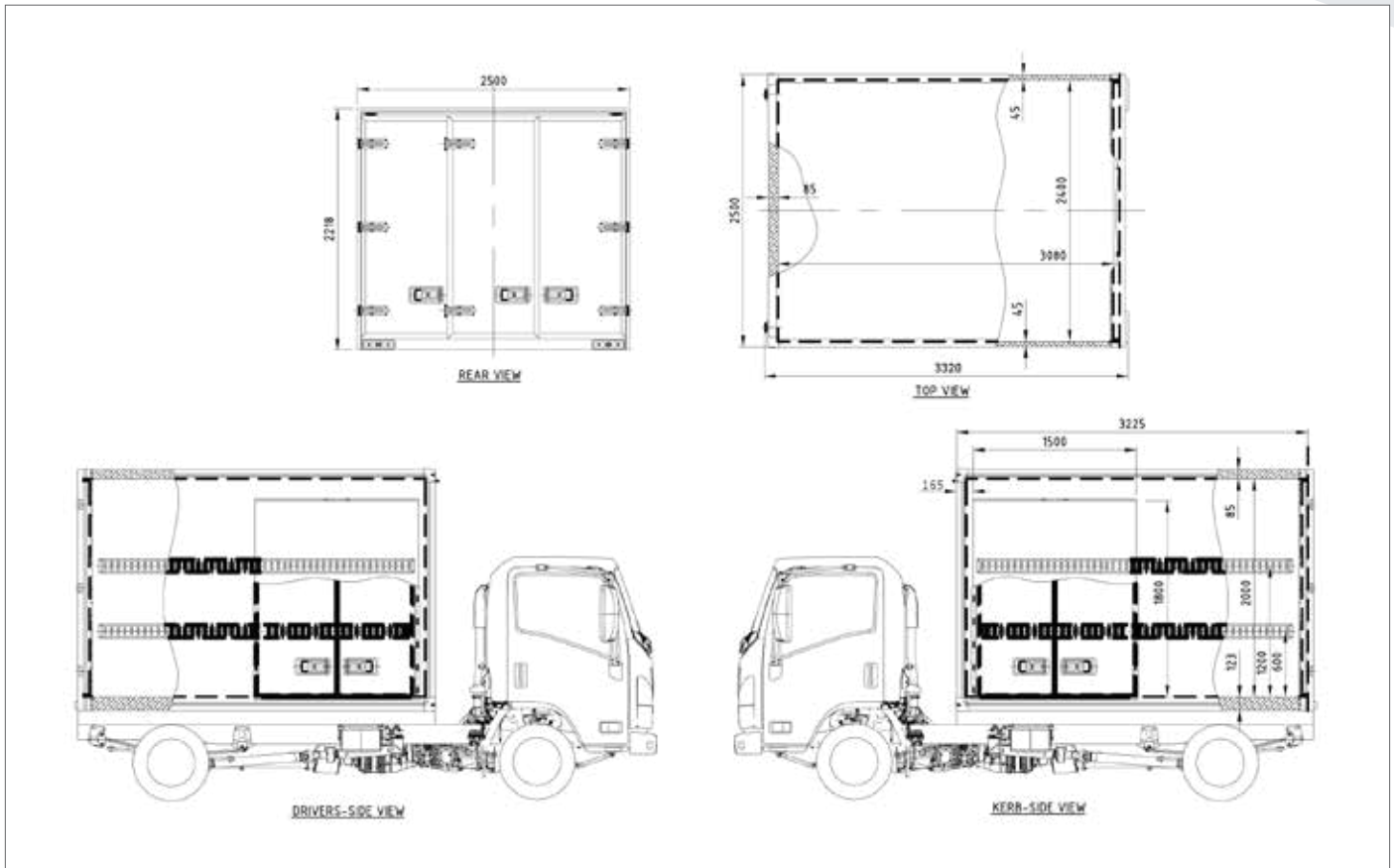

Our Fibreglass bodies are engineered and designed to provide superior insulation and durability, manufactured with quality fibreglass and insulation materials across our entire range of freezer spec bodies.

## FEATURES & BENEFITS

- » State of the Art Panel Technology FRP/PUR/FRP
- » Fibreglass non-slip flooring and internal kick plates
- » Double Side Doors on Both Sides
- » Internal recessed lights and recessed switch
- » Stainless steel recessed door hardware and aluminium
- » Extrusions (less extrusions when adding decals for advertising)
- » Interior LED Cargo light and rear running lights and exterior
- » Reflectors
- » EPDM Rubber Seal
- » 24 Months Structural and Hardware Warranty
- » Truck Body Weight: Approx. 1065Kg (Fitted body without fridge)



Fibreglass Non-slip  
Flooring



Internal recessed lights



# TMB4200W SERIES

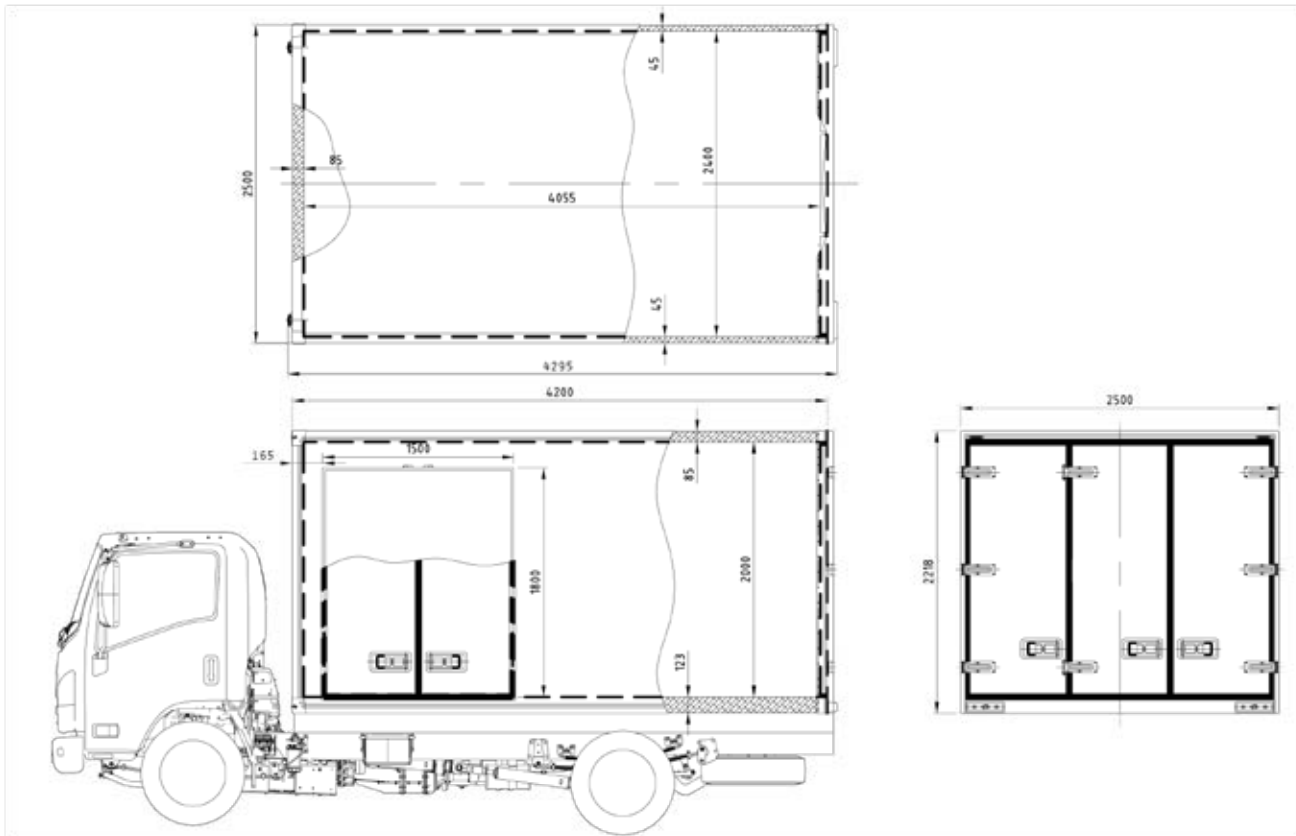

Our Fibreglass bodies are engineered and designed to provide superior insulation and durability, manufactured with quality fibreglass and insulation materials across our entire range of freezer spec bodies.

## FEATURES & BENEFITS

- » State of the Art Panel Technology FRP/PUR/FRP
- » Fibreglass non-slip flooring and internal kick plates
- » Internal recessed lights and recessed switch
- » Stainless steel recessed door hardware and Aluminium extrusions (less extrusions when adding decals for advertising)
- » Interior LED Cargo light and rear running lights and exterior reflectors
- » EPDM Rubber Seal
- » 24 Months Structural and Hardware Warranty
- » Truck Body Weight: Approx. 1215Kg (Fitted body without fridge)



Fibreglass Non-slip  
Flooring



Internal recessed lights



*Quality you can count on to get the job done*

# TMB5500W SERIES

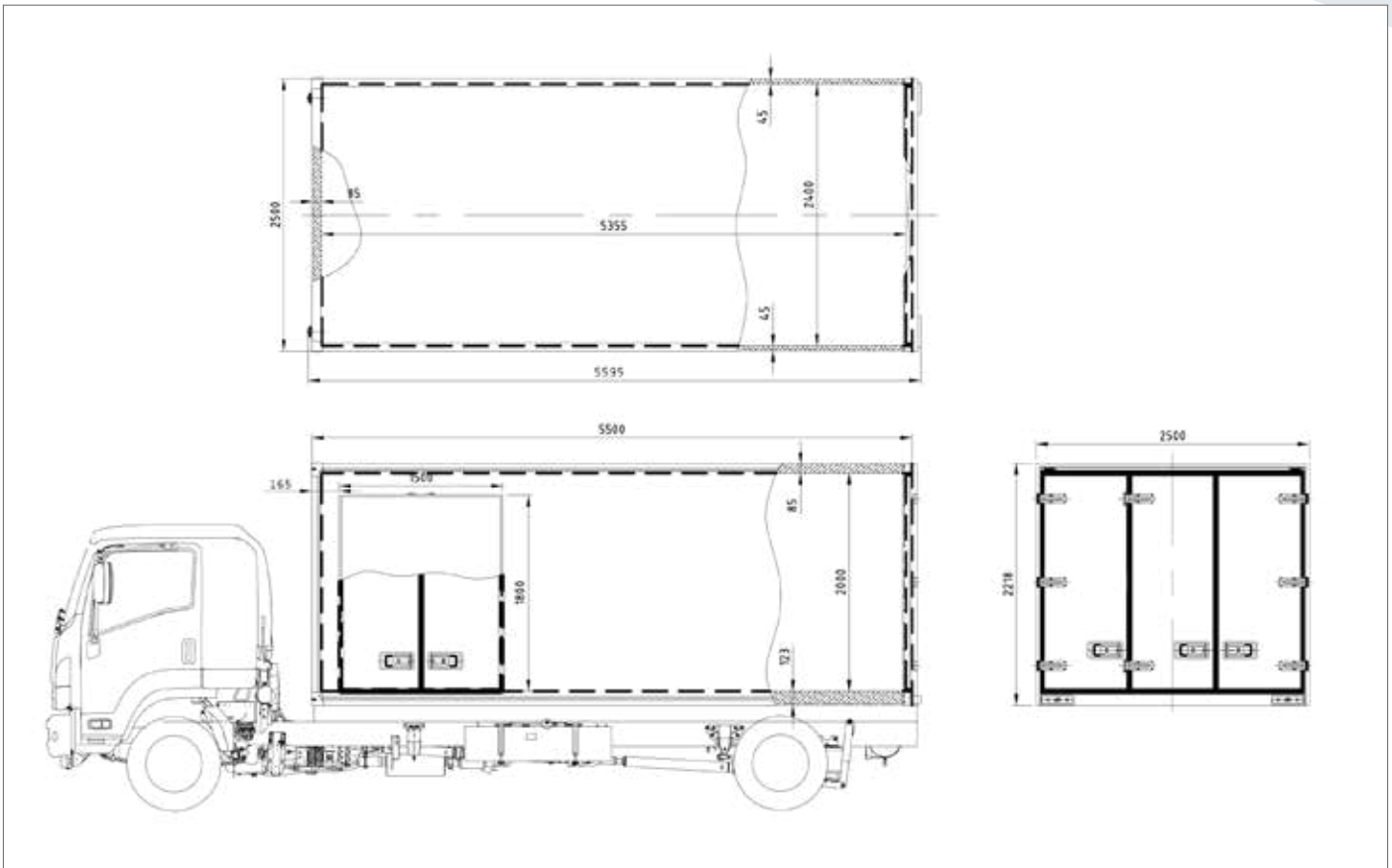

Our Fibreglass bodies are engineered and designed to provide superior insulation and durability, manufactured with quality fibreglass and insulation materials across our entire range of freezer spec bodies.

## FEATURES & BENEFITS

- » State of the Art Panel Technology FRP/PUR/FRP
- » Fibreglass non-slip flooring and internal kick plates
- » Internal recessed lights and recessed switch
- » Stainless steel recessed door hardware and Aluminium extrusions (less extrusions when adding decals for advertising)
- » Interior LED Cargo light and rear running lights and exterior reflectors
- » EPDM Rubber Seal
- » 24 Months Structural and Hardware Warranty
- » Truck Body Weight: Approx. 1310Kg (Fitted body without fridge)



Fibreglass Non-slip  
Flooring



Internal recessed lights



# FRAMEC BODIES



**Digital Thermostat**

Temperature setting control through digital thermostat



**Door**

Door with high density polyurethane frame completely covered with 18/8 stainless steel, high impact resistance.



**140 mm HP INSULATION**

140 mm ceiling and floor panels, for an increased insulation



**Handle**

Ergonomic handle, Framec exclusive (available also with heavy duty handle).



**Without subframe**

Framec body's main characteristic is the absence of the sub frame, which increase the payload.



**Corner protection**

Corner protection shockproof. It adds soundness to the body.

## Today's customers demand larger capacity bodies with higher energy savings.

Framec refrigerated bodies are durable, operate efficiently and importantly, allow for the transport of larger quantities of goods. This has been achieved with the use of special light weight paneling that has high structural resistance (130mm). Equipped with side doors without electric resistance, double room gaskets and a self-supporting floor, there is no need for a subframe which equates to a better payload.

**1. Framec body's main characteristic is the absence** of the sub frame, which increases the payload.

**2. Ergonomic handle, Framec exclusive** (available also with heavy duty handle).

**3. Remote refrigeration unit** mobile independent unit that increases the payload.

**4. Energy saving guaranteed** with special No frost gaskets without electrical resistance which allow easy opening of the doors and excellent insulation with anti-condensation.

**5. Double compartment rubber gasket** that perfectly isolates the door.

**6. Internal and external led lights.**

**7. Standard equipment for Framec body** is the inner wheel box, thanks to the absence of the sub frame.

**8. Framec technology side doors available in different sizes:** mm 550 x 1100h, 550 x 900h and 650 x 1300h, 130mm thickness.

**9. Temperature setting control** through digital thermostat.

## Eutectic Refrigeration

Lower Cold Loss – the eutectic bodies guarantee a lower cold loss compared to standard bodies with ventilation units

Lower Energy Consumption – to maintain the temperature during the delivery process, you just have to connect electrically during shift stops

Lower Maintenance – highly efficient and completely electric



**MADETO  
MEASURE**

AVAILABLE FROM 2 TO 9 METRES LENGTH  
CUSTOMISED SOLUTIONS FOR ALL TASTES

Call or email us - [sales@thermalmark.com.au](mailto:sales@thermalmark.com.au) P: 1300 798 380 for a quote or visit [www.thermalmark.com.au](http://www.thermalmark.com.au) to download the full FRAMEC catalogue



# FRAMEC TRUCK

Framec refrigerated bodies are available with side doors (symmetrically placed on both sides) allowing easy access to all your products and lowering cold loss during the delivery process.

Custom made with your choice of double or triple rear swing doors making it easy to load pallets or roll-containers. Dimensions range from 2 metres (suitable for urban solutions) up to 9 meters (to transport large quantities on long distance travels.)



## LIGHT DUTY SOLUTION

Ideal for 2.5t and under requirements



## MEDIUM DUTY SOLUTION

Ideal for 3.5t - 6.5t requirements



## HEAVY DUTY SOLUTION

Ideal for up to 6.5t requirements

# MULTI-TEMPERATURE BODIES

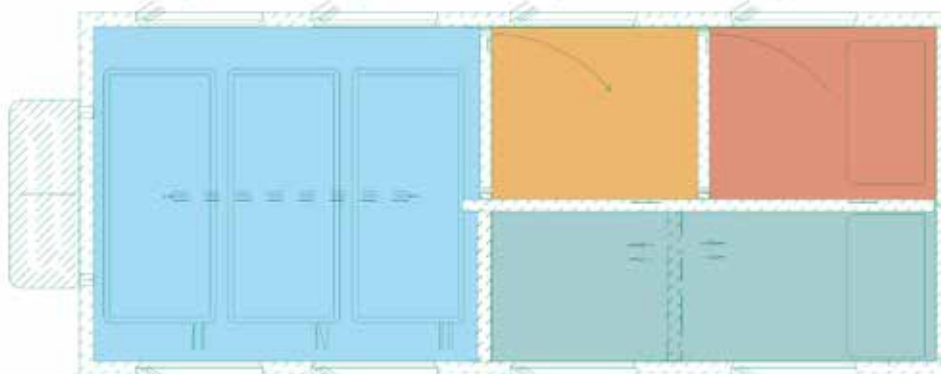

*Different temperatures for all kind of products*

**Cold** **Fresh** **Dry** **Hot**

Multi-temperature bodies represent the perfect solution to meet the necessities of those requiring different temperatures within the same body.

With this option you can have a set-up with a low temperature compartment (-33° C) to transport ice cream and frozen food, one compartment with a positive temperature (+2° C / +4° C) for fresh food and a third compartment, isothermal, for dry foods and beverages.

Eutectic plates and ventilated systems guarantee refrigeration and storage of different types of product.



**MADETO  
MEASURE** AVAILABLE FROM 2 TO 9 METRES LENGTH  
CUSTOMISED SOLUTIONS FOR ALL TASTES

Call or email us - [sales@thermalmark.com.au](mailto:sales@thermalmark.com.au) P: 1300 798 380 for a quote  
or visit [www.thermalmark.com.au](http://www.thermalmark.com.au) to download the full FRAMEC catalogue



# VAN INSULATION & REFRIGERATION

From chilled to frozen, Thermal Mark is the first choice when it comes to converting vans for refrigerated transport. Our experienced teams will custom design a refrigerated transport solution to meet your specific requirements. We are known for our efficient, cost-effective results.

## Why choose from Thermal Mark's Refrigerated Van Range?

- » We guarantee temperature.
- » We guarantee quality.
- » We guarantee a fast delivery date.
- » Unique design that complies with new vehicle warranties.
- » Custom insulation to suit your delivery requirements.
- » Experienced back-up and quality service.

## Refrigeration System

- » Performance ABS Slimline Evaporator Unit
- » Performance Under Mount Condenser Unit – Operates independent to cabin air conditioner
- » In-cab Control with Digital Display
- » Guaranteed Temperature Performance to -5 Degrees Celsius for Chillers and -18 Degrees Celsius for Freezers

## Van Insulation

- » Custom moulded fiberglass insulation - 75mm Chiller and 100mm Freezer Insulation
- » Checker Plate Wheel Arch Protectors
- » Interior Cargo Lights
- » Customized design to suit your requirements (Dividers, Load Restraint Options, Cargo Packs, Electric Standby)

## Warranty

- » 100% Thermal Mark Product Satisfaction Guarantee
- » 12 Months Refrigeration System Warranty\*
- » 12 Months TMTR Insulation Structural Warranty\*



# THERMO KING T1000R



## Delivering what matters

An extensive range of single and multi temperature units means there is a model to suit all trucks, from the smallest to the largest.



Through extensive development and field experience, Thermo King have found the right balance between system efficiency, fuel consumption and performance in all ambient conditions for both fresh and frozen produce.

- Quiet operation
- Low fuel consumption
- Low life cycle costs
- Easy to use and service
- Reduced emissions and waste

## T1000R Specifications

### SYSTEM NET COOLING CAPACITY UNDER A.T.P. CONDITIONS AT 30° C AMBIENT

Temperature	Capacity on Engine Power	Capacity on Electric Standby
0°C	9600 W	6700 W
-20°C	5300 W	4100 W

### Airflow ON HIGH SPEED ENGINE OPERATION

Airflow volume @ 0 pa static pressure 3200 m3/hr

Discharge velocity - 6.2 m/sec

Refrigerant R-404A/R-452A

### Unit Dimensions (mm/ WxDxH)

1887 x 919 x 688 - approx. 514kg

*Quality you can count on to get the job done*

# THERMO KING SLX400



## The next generation in transport refrigeration

The SLX brings significant innovations to maximise profitability while minimising environmental impact within a sustainable transport and delivery process.



- Reliable operation
- Lowest emissions
- Increased shelf life
- Easier installation
- Lowest noise level
- Proven components
- Optimal data monitoring and management

### SLX400 Specifications

#### SYSTEM NET COOLING CAPACITY UNDER A.T.P. CONDITIONS AT 30° C AMBIENT

Temperature	Capacity on Engine Power	Capacity on Electric Standby
0°C	18400 W	13200 W
-20°C	9900 W	7100 W

#### Airflow ON HIGH SPEED ENGINE OPERATION

Airflow volume @ 0 pa static pressure	5500 m3/hr
Airflow volume in fully loaded trailer	5100 m3/hr
Discharge velocity - airthrow	16 m/sec
Refrigerant	R-452A

#### Unit Dimensions (mm/ WxDxH)

2076 x 537.4 x 2279- approx. 792kg

*Quality you can count on to get the job done*



**THERMAL MARK**  
TRANSPORT REFRIGERATION

# PARTS, SERVICE & FIBERGLASS REPAIRS

TMTR Service, Transport Refrigeration & Fiberglass Body Repairs Supporting what we sell is a motto we live by. It's this attitude and the professional services we provide that has made us the largest independent repairer of Transport refrigeration in NSW.

We have over 10 years' experience servicing mixed fleets. Whether you have Carrier, Thermo King or any other brand of units, you're in good hands.

We stock a comprehensive inventory of quality spare parts covering all major brands. Whatever the issue and regardless of brand, we have the necessary skills and technology.

Let us help you by providing:

- » Onsite servicing: with our own fully equipped service vehicles
- » Programmed Maintenance: Pre-trip inspections weekly and monthly are proven to reduce your breakdowns.
- » Maintenance schedules: Full engine and refrigeration service at regular intervals by trained professionals.
- » Calibration Certificates: Making sure your sensitive freight is kept at the correct temperature.
- » 24 hour Emergency Service: Keeping your fleet running after hours.
- » Australia-wide service: We have a network of independent repairers Australia wide.
- » Service reminders: We can remind you when your service is due.
- » Service exchange: we stock re-conditioned compressors and engines for service exchange.